

Deluxe Servalot

Part No. 40111EX
Revised June 1996

Instruction Manual

Models #2185EX, #2186EX, #2187EX, #2188EX and #2189EX





 **GOLD MEDAL**®

FUNFOOD EQUIPMENT & SUPPLIES

Cincinnati, OH 45241-4807 USA

SAFETY PRECAUTIONS

	⚠ CAUTION
	This equipment is designed and sold for commercial use only. This equipment is not to be used by the consumer in home use. Do not allow direct contact of this equipment by the public when used in food service locations. Only personnel trained and experienced in the equipment operation may operate this equipment. Carefully read all installation instructions before operating the equipment.

	⚠ WARNING
	Always wear safety glasses when servicing this equipment.

	⚠ WARNING
	NEVER put your fingers or any object into the heating area. We do NOT assume any liability for injury due to careless handling or operation of this equipment.

	⚠ WARNING
	Any alterations to this equipment will void the warranty and may cause a dangerous situation. NEVER make alterations to the equipment.

	⚠ DANGER
	Machine must be properly grounded to prevent electrical shock to personnel. Do NOT immerse the equipment in water. Always unplug the equipment before cleaning or servicing.

NOTE

The information, specifications and illustrations contained in this manual represent the latest data available at time of publication. Right is reserved to make changes as required at the discretion of Gold Medal Products Company without notice.

INSTALLATION

This instruction manual and parts listing covers the following Deluxe Servalot warmer models: #2185EX, #2186EX, #2187EX, #2188EX and #2189EX.

Clean your Deluxe Servalot thoroughly upon arrival to remove any debris left from manufacture (see "CARE AND CLEANING" instructions).

CHECKING SHIPMENT

Your new Deluxe Servalot is shipped completely assembled, ready to operate. After removing the corrugated carton from the machine, check thoroughly for any damage which may have occurred in transit. Claims should be filed immediately with the transportation company.

ELECTRICAL REQUIREMENTS

Model No.	Voltage	Hertz	Wattage
#2185EX & #2187EX	230	50	90
#2186EX & #2188EX	230	50	90
#2189EX	230	50	111

A switch on the bottom pan controls both the heater and light bulb. The strip heater on the underside of the bottom pan keeps popcorn/nachos warm and fresh in the cabinet. A yellow shatterproof light bulb also serves as to warm popcorn/nachos while illuminating the top portion of the cabinet.

CAUTION: When replacing the 11 WATT yellow light bulb, do not use a larger watt bulb or a bulb that is not shatterproof.

OPERATION

LOADING PRODUCT

To load your Deluxe Servalot, remove the lid and pour in product. For the best display, fill your warmer $\frac{3}{4}$ full.

LOCATION

Always pick a good location for your warmer, so that the public can see the attractive display. A front counter location is usually best.

CARE AND CLEANING

The aluminum frame of the Deluxe Servalot is easy to keep clean. Usually a damp cloth will remove all dirt and grease spots. NEVER use abrasives on aluminum framework. The plexiglass should also be kept clean. Clean the inside and outside of the plexiglass with a soft cloth and a non-abrasive cleanser. **CAUTION:** Do NOT immerse the machine in water! The heating element and wiring were not designed for immersion, water will ruin the heater and cause short circuits in the wiring.

INSTALLING DECAL

Decals have been shipped with your warmer and are to be installed at the top of the customer side. Install only one decal. The decal you choose should be the food type you will warm. Before installation, clean the area with a mild soap and water. Thoroughly dry the area with a soft cloth. Put the decal in place and remove backing a bit at a time, squeegee as you go. If air bubbles occur, puncture and smooth down with a squeegee.

SUCTION FEET KIT INSTALLATION

INSTALLATION ON P-60 POPCORN MACHINES

1. Unplug your machine.
2. Remove drop panel.
3. Remove corn pan from P-60
4. Remove the 4 feet by removing the 4 mounting screws with a 1/4" wrench.
5. Install suction cups in place of feet. Put on lockwashers & nuts and tighten with a 11/32" wrench. (Caution: Do not overtighten.)
6. Reassemble your machine.

INSTALLATION ON DELUXE SERVALOT WARMERS

1. Unplug your machine.
2. Remove drop panel.
3. Remove mounting screws from warmer pan on Dix Servalot using a small screwdriver. Lift the warmer pan up, but do not take out. (Caution: Wiring is connected to the warmer pan, lift carefully so to not pull the wires loose.)
4. Remove the 4 feet by removing the mounting screws with a 1/4" wrench.
5. Install suction cups in place of feet. Put on lockwashers & nuts and tighten with a 11/32" wrench. (Caution: Do not overtighten.)
6. Reassemble your machine.

TYPICAL CORNER

Part No. 40058
 Kit includes:
 4) Suction Feet
 4) No. 8, 32 Hex Nuts
 4) No. 8 Lockwashers

INSTALLATION INSTRUCTIONS			
USED ON	SUCTION FEET KIT		
DWH. G.R.O.	DATE 8-17-82	DO NOT SCALE	TOLERANCES UNLESS OTHERWISE SPECIFIED
APP'VD	DATE	DRAWING	PART NO. 40058
MATERIAL	SCALE		DWG. A-4443
GOLD MEDAL PRODUCTS CO. 1828 FREEMAN AVE. - CINCINNATI, OHIO 45214			

MAINTENANCE INSTRUCTIONS

	⚠ CAUTION
	THE FOLLOWING SECTIONS OF THIS MANUAL ARE INTENDED ONLY FOR QUALIFIED SERVICE PERSONNEL WHO ARE FAMILIAR WITH ELECTRICAL EQUIPMENT. THESE ARE NOT INTENDED FOR THE OPERATOR.

	⚠ WARNING
	Adequate eye protection must be used when servicing this equipment to prevent the possibility of injury.

	⚠ DANGER
	Do NOT immerse the equipment in water. Unplug your machine before servicing.

ORDERING SPARE PARTS

1. Identify the desired part by checking it against the photos, illustrations, and/or the parts list.
2. When ordering, please include part number, part name, and quantity desired.
3. Please include your model name and machine serial number (located on the machine nameplate) with your order.
4. Address all parts orders to:

Parts Department
Gold Medal Products Co.
10700 Medallion Drive
Cincinnati, Ohio 45241-4807

or, place orders at:

(513) 769-7676
Fax: (513) 769-8500
E-mail: goldme19@eos.net

DELUXE SERVALOT WARMER ASSEMBLY

Models #2185EX, #2187EX and #2189EX

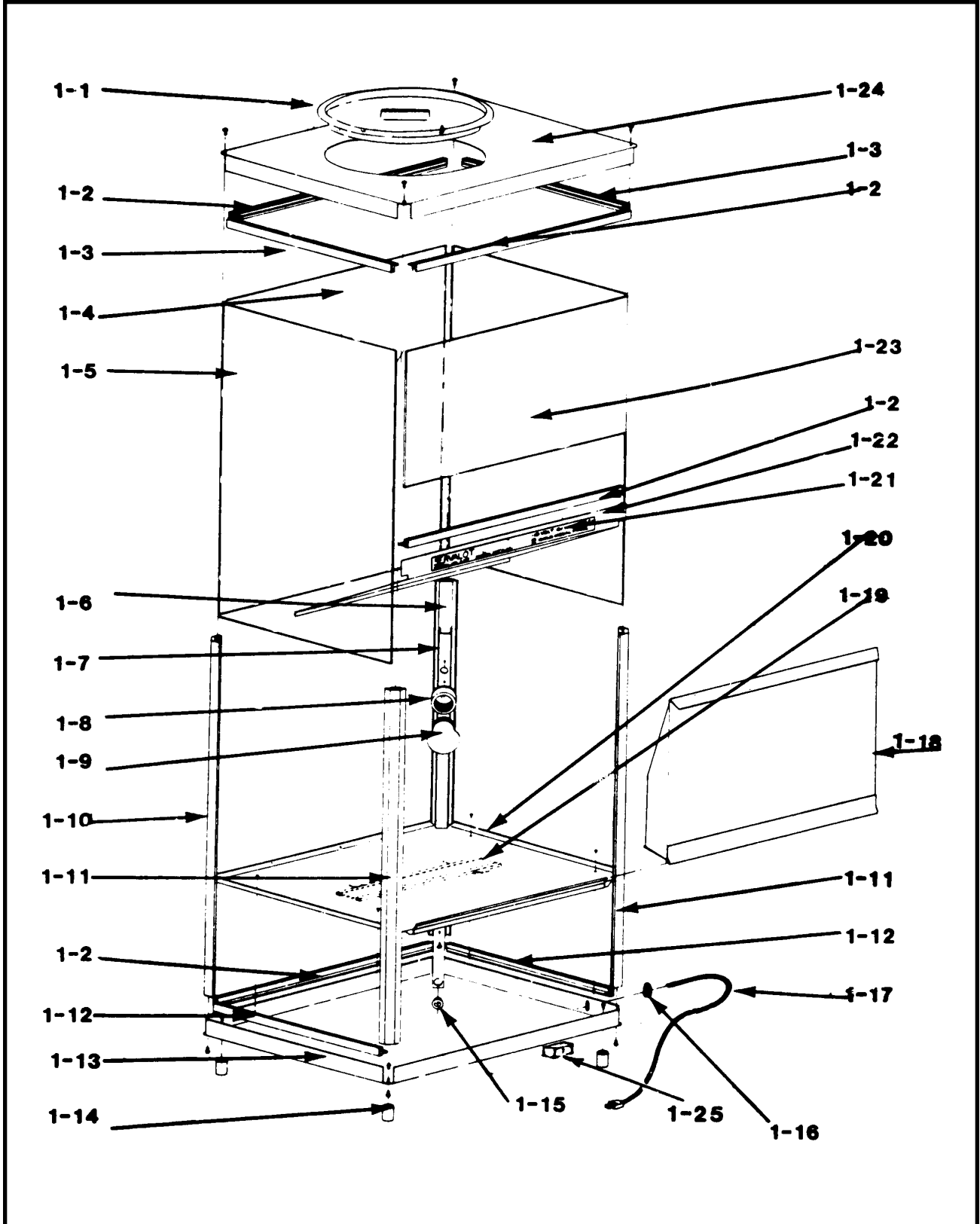

PARTS LIST – DELUXE SERVALOT WARMER ASSEMBLY

Models #2185EX, #2187EX and #2189EX

Item No.	Model #2185EX Part No.	Model #2187EX Part No.	Model #2189EX Part No.	Description
1-1	40002	40002	40002	Lid
1-2	40039	40039	49004	Top Retaining Extrusion
1-3	40039	40039	49004	Top Retaining Extrusion
1-4	40013	40013	49018	Plexiglas Front
1-5	40014	40014	49018	Plexiglas Side
1-6	40006	40006	40062	Left Front Corner Post
1-7	40011	40011	40064	Light Support Channel
1-8	40012	40012	40012	Light Receptacle
1-9	n/a	n/a	n/a	Light Bulb, 11 Watt
1-10	40005	40005	49006	Right Front Corner Post
1-11	40007	40007	40063	Rear Corner Post
1-12	40021	40021	40068	Bottom Retaining Extrusion
1-13	40323	40323	40061	Bottom Pan
1-14	47328	47328	47328	Glide
1-15	75328	75328	75328	Bushing, 5/16" [7,9mm] I.D. Plastic
1-16	44073	44073	44073	Strain Relief SR-6P3-4
1-17	42369	42369	42369	Power Supply Cord
	n/a	n/a	n/a	Black Wire Nut
1-18	40118	40118	40123	Drop Panel Assembly
1-19	40113	40113	40113	Heat Element
1-20	40117	40117	40124	Warmer Pan
1-21	40136	40131	40070	Dataplate
1-22	40009	40009	40065	Baffle
1-23	40015	40015	n/a	Plexiglas Rear
1-24	40003	40003	40060	Top Pan
1-25	40320	40320	40320	Rocker Switch
	40043	n/a	40060	Nachos Decal
	40053	40052	n/a	Popcorn Bowl Decal
	49123	49123	n/a	Crutch Tip
	40050	40050	40050	Protective Angle Light Bulb
	47561	47561	47561	Magnetic Catch

DELUXE SERVALOT WARMER ASSEMBLY

Models #2186EX and #2188EX

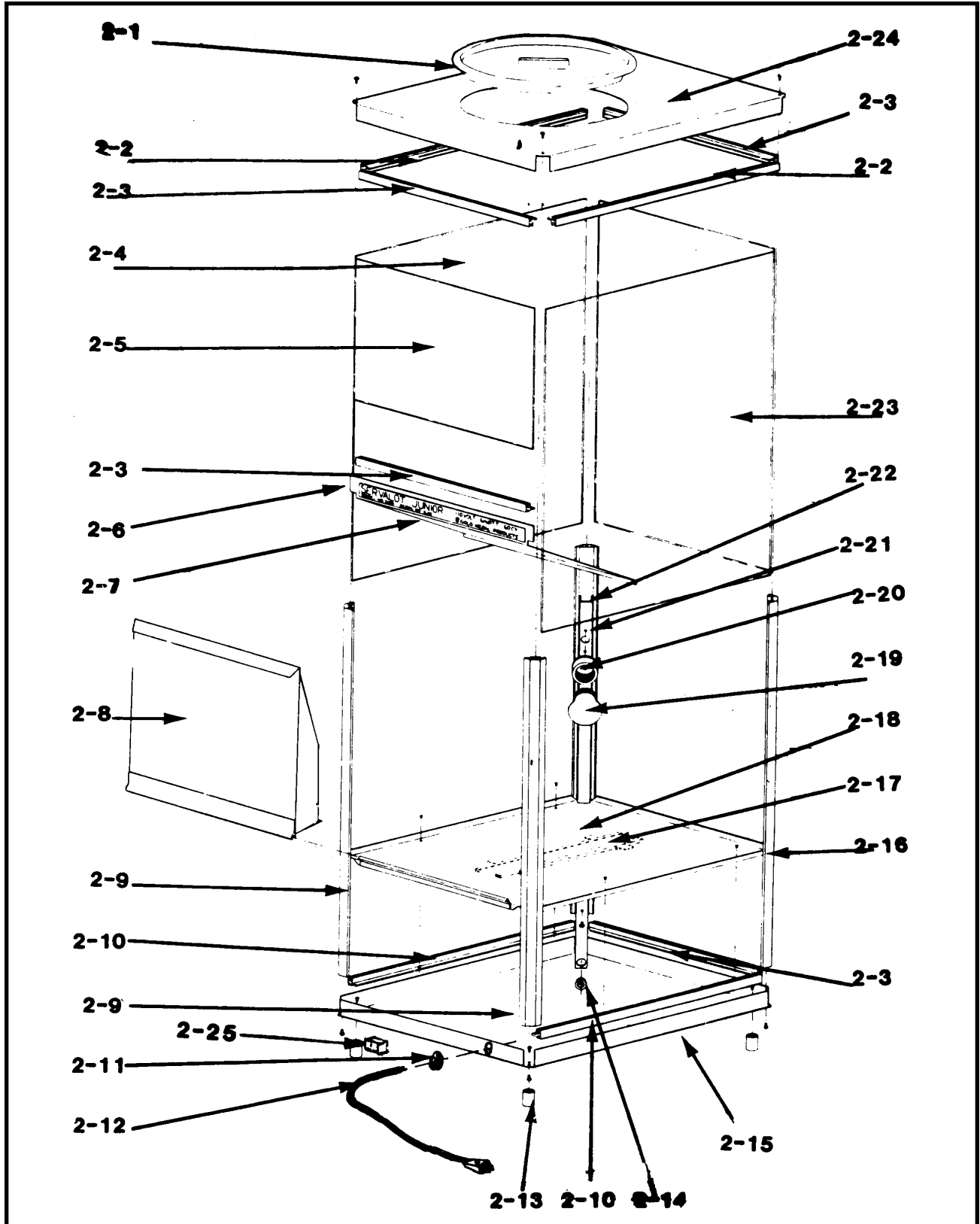

PARTS LIST – DELUXE SERVALOT WARMER ASSEMBLY

Models #2186EX and #2188EX

Item No.	Model #2186EX Part No.	Model #2188EX Part No.	Description
2-1	40008	40008	Lid
2-2	40039	40039	Top Retaining Extrusion
2-3	40039	40039	Top Retaining Extrusion
2-4	40013	40013	Plexiglas Side
2-5	40016	40016	Plexiglas Rear
2-6	40010	40010	Baffle
2-7	40154	40055	Dataplate
2-8	40107	40107	Drop Panel Assembly
2-9	40007	40007	Rear Corner Post
2-10	40039	40039	Bottom Side Extrusion
2-11	44073	44073	Strain Relief
2-12	42369	42369	Power Supply Cord
2-13	47328	47328	Glide
2-14	75328	75328	Bushing, $\frac{5}{16}$ " [7,9mm] I.D. Plastic
2-15	40322	40322	Bottom Pan
	N/A	N/A	Black Wire Nut
2-16	40005	40005	Right Front Corner Post
2-17	40113	40113	Heat Element
2-18	40109	40109	Warmer Pan Assembly
2-19	N/A	N/A	Light Bulb, 11 Watt
2-20	40012	40012	Light Receptacle
2-21	40011	40011	Light Support Channel
2-22	40006	40006	Left Font Corner Post
2-23	40014	40014	Plexiglas Front
2-24	40174	40174	Top Pan
2-25	40320	40320	Rocker Switch
	40044	N/A	Nachos Decal
	N/A	40053	Popcorn Bowl Decal
	49123	49123	Crutch Tip
	40050	40050	Protective Angle Light Bulb
	47561	47561	Magnetic Catch

WIRING SCHEMATIC

MODEL	HEAT ELEMENT WATTAGE	REVISIONS	
		DESCRIPTION	DATE BY CAD
2185EX	50		
2186EX	50		
2187EX	75		
2188EX	75		
2179EX	50		

HEAT ELEMENT
(SEE CHART FOR WATTAGE)

DOUBLE POLE
SINGLE THROW
LIGHTED ROCKER
SWITCH

LEAD-IN CORD
 BROWN
 GRN/YEL
 LT BLUE

NOTE:
 ALL WIRE IS #18 AWG LABELED APPLIANCE WIRING MATERIAL WITH AT LEAST 1/32" THERMOPLASTIC INSULATION RATED AT LEAST 105° C. WIRE MUST BE UL LISTED AND CSA CERTIFIED.

WIRING DIAGRAM		WARNERS		DO NOT SCALE DRAWING	
USED ON	DATE	DATE	DATE	SCALE	PART NO.
	3-10-82			FULL	
DRN. REV#	APPROD.	DATE	DATE	SCALE	PART NO.
TOLERANCES			DO NOT SCALE DRAWING		
FRACTIONS 1/2 - 015					
DECIMALS 1/10 - 005					
PERCENTS 1/10 - 0005					
			COLD MEDAL PRODUCTS CO. CHICAGO, ILL. 60604		
			DWG. NO. A-7656		

WARRANTY

WE WARRANT to the original purchaser the Gold Medal equipment sold by us to be free from defects in material or workmanship under normal use and service. Our obligation under this warranty shall be limited to the repair or replacement of any defective part for a period of six (6) months from the date of sale to the Original Purchaser with regard to labor and two (2) years with regard to parts and does not cover damage to the equipment caused by accident, alteration, improper use, voltage, abuse, or failure to follow instructions.

THIS WARRANTY IS IN LIEU OF ALL OTHER WARRANTIES EXPRESSED OR IMPLIED, AND OF ALL OTHER OBLIGATIONS OR LIABILITIES ON OUR PART, INCLUDING THE IMPLIED WARRANTY OF MERCHANTABILITY. THERE ARE NO WARRANTIES WHICH EXTEND BEYOND THE DESCRIPTION ON THE FACE HEREOF. We neither assume, nor authorize any other person to assume for us, any other obligation or liability in connection with the sale of said GOLD MEDAL equipment or any part thereof.

The term "Original Purchaser" as used in this warranty shall be deemed to mean that person, firm, association, or corporation who was billed by the GOLD MEDAL PRODUCTS COMPANY, or their authorized distributor for the equipment.

THIS WARRANTY HAS NO EFFECT AND IS VOID UNLESS THE ORIGINAL PURCHASER FIRST CALLS GOLD MEDAL PRODUCTS COMPANY AT 1-800-428-2676 TO DISCUSS WITH OUR SERVICE REPRESENTATIVE THE EQUIPMENT PROBLEM, AND, IF NECESSARY, FOR INSTRUCTIONS CONCERNING THE REPAIR OR REPLACEMENT OF PARTS.

NOTE: This equipment is manufactured and sold for commercial use only.



GOLD MEDAL PRODUCTS COMPANY
10700 Medallion Drive
Cincinnati, OH 45241-4807 USA